

High Performance Cavity Tray Systems

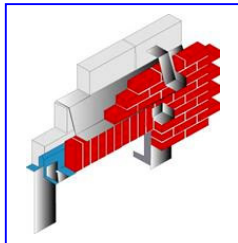

D-sign Ltd is an independent design consultancy that supplies high performance DPCs and associated waterproofing products. We have over 20 years experience of working within the construction industry and have developed a level of expertise in DPC installation that is unrivalled. DPC is available in standard roll widths within 48 hours and non-standard within 3 to 4 days, also available in white and brown.

Standard Units

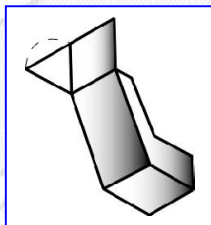

Detailing, as recommended in BS 5628 part 3, includes the use of factory welded preformed units where there are projecting columns within cavities, brickwork supports, arches and openings, ramp access, expansion joints, intermediate fire barriers, roof details and copings. Preformed shapes are available to suit change of level or direction and bespoke shapes are available to suit virtually any profile necessary.

Joint Support Systems

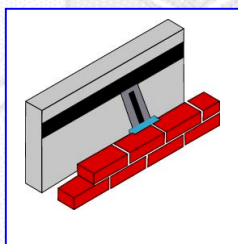

In brick/block situations where the cavity tray is being built into both the inner and outer leaf, the tray is sandwiched within the mortar joints on each course. Where joints are formed in the linear run, a joint support should be used to allow positive forming of the joint which is left in as part of the system.

Advisory Service

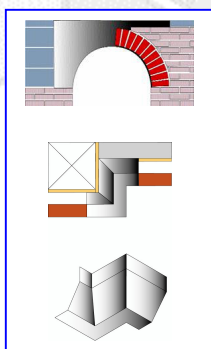

We are able to provide a complete specification for design and take-off for DPCs, cavity trays and associated waterproofing products. We offer independent advice, together with three dimensional designs for preformed units. This ensures continuity of waterproofing systems for below and above ground on major projects. Whether as a ground level DPC or fully designed cavity tray system for multi-storey use, we can supply a range of materials to suit your specific requirements.

DPC Accessories

We also provide a full range of DPC accessories, including butyl jointing tapes, fixing strips and a unique joint support system to simplify installation.

Technical Details

Detailed isometric drawings can be provided and virtually any profile manufactured to suit all detailing for cavity tray systems. Pre-formed units are high frequency welded, electronically tested and provide a good practice alternative to on-site cutting and sticking to conform with British Standards.

Payload

Payload is available in black, brown or white to blend in with facing brickwork or stonework. A high performance thermoplastic polymeric product, Payload out-performs traditional dpcs and will not exude. It is more competitive than calendered sheet rubber products and the bond strength achieved is stronger than the mortar/brick bond.

Payload GR

Payload GR provides protection against the entry of gases when sealed to both the slab membrane and through the cavity. The use of factory welded preformed units i.e. pipe penetrations, corners, stop ends and changes of level must be used as part of a gas protection scheme for either a passive or active system. Payload GR conforms to the current BRE (British Research Establishment) requirements for use as part of a gas resistant membrane system.

Plytherm Insulated DPC

Plytherm Insulated dpc is designed for use in cavity wall construction at window/door openings to eliminate cold bridging, by providing thermal efficiency together with continuity of the waterproofing at these critical areas.

The following standard roll widths are available in black, white and brown.
Other roll widths are available on request.

| Roll Width | Length | m2 |
|------------|----------|------|
| 100mm | 20metres | 2 |
| 112.5mm | 20metres | 2.25 |
| 150mm | 20metres | 3 |
| 225mm | 20metres | 4.5 |
| 300mm | 20metres | 6 |
| 337.5mm | 20metres | 7.5 |
| 450mm | 20metres | 9 |

Whatever size of project, we can detail and design an appropriate solution.